

**FOUNTAIN AREA RESTORATION PLAN**

SCALE \_\_\_\_\_ 1" = 10'-0"  
 NOTE: SCALE IS 1" = 20'-0" IF PRINTED ON 11"X17" PAPER

**Jeffrey C. Beitel**  
 ARCHITECTURE  
 610-738-8933  
 228 East Biddle St.  
 West Chester, PA 19380

**RESTORATION OF THE:  
 HISTORIC MARSHALL SQUARE PARK FOUNTAIN**

ANNE F. WALTERS COMPANY  
 LANDSCAPE ARCHITECTS

224 EAST BIDDLE STREET WEST CHESTER PENNSYLVANIA 19380.2750  
 TELEPHONE 610.429.4533 FACSIMILE 610.429.0293  
 Members of the American Society of Landscape Architects

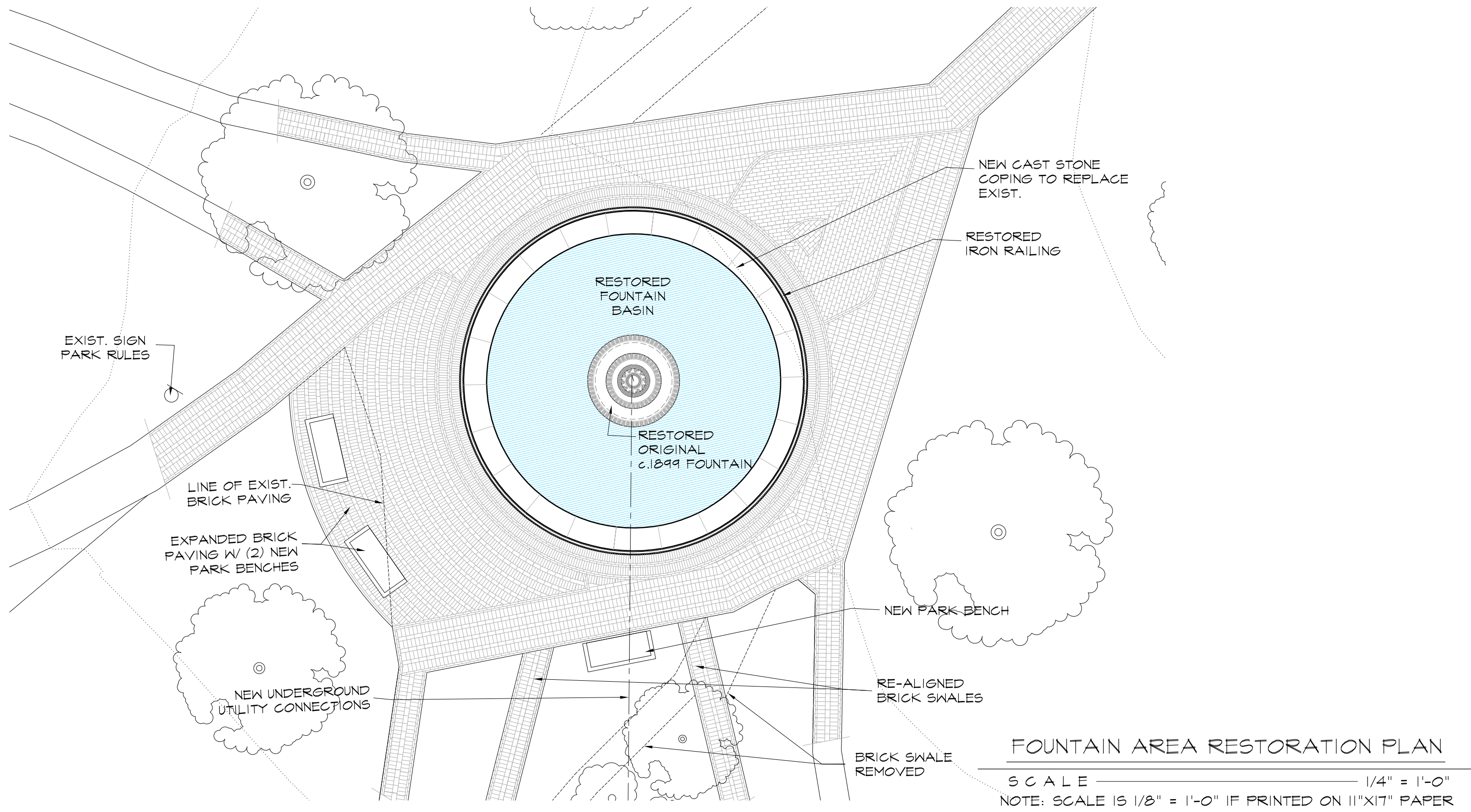

**FOUNTAIN AREA RESTORATION PLAN**

SCALE ————— 1/4" = 1'-0"  
 NOTE: SCALE IS 1/8" = 1'-0" IF PRINTED ON 11"X17" PAPER



**Jeffrey C. Beitel**  
 ARCHITECTURE  
 610-738-8933  
 228 East Biddle St.  
 West Chester, PA 19380

**RESTORATION OF THE:  
 HISTORIC MARSHALL SQUARE PARK FOUNTAIN**

ANNE F. WALTERS COMPANY  
 LANDSCAPE ARCHITECTS



224 EAST BIDDLE STREET WEST CHESTER PENNSYLVANIA 19380.2750  
 TELEPHONE 610.429.4533 FACSIMILE 610.429.0293  
 Members of the American Society of Landscape Architects



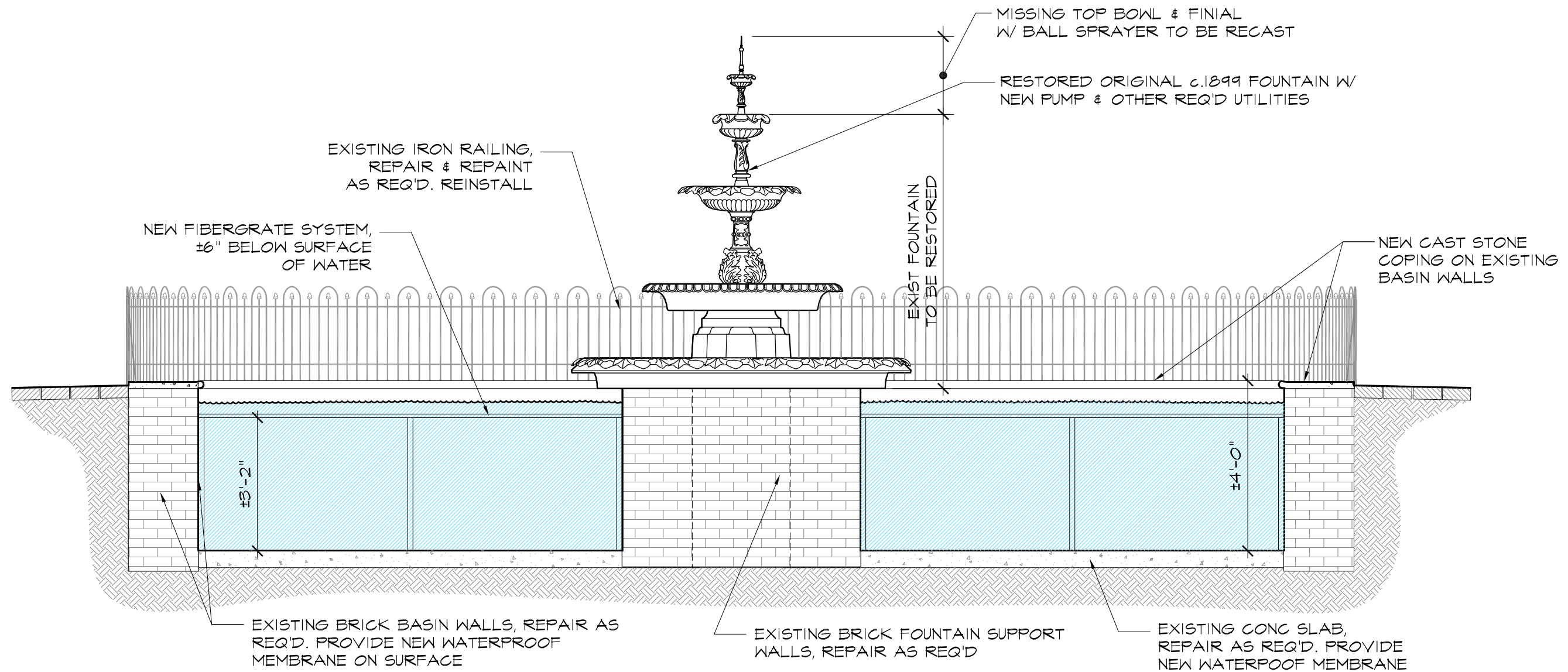

SECTION THROUGH PROPOSED FOUNTAIN

SCALE ————— 3/4" = 1'-0"

NOTE: SCALE IS 1/2" = 1'-0" IF PRINTED ON 11"X17" PAPER



**Jeffrey C. Beitel**  
 ARCHITECTURE  
 610-738-8933  
 228 East Biddle St.  
 West Chester, PA 19380

**RESTORATION OF THE:  
 HISTORIC MARSHALL SQUARE PARK FOUNTAIN**

ANNE F. WALTERS COMPANY  
 LANDSCAPE ARCHITECTS



224 EAST BIDDLE STREET WEST CHESTER PENNSYLVANIA 19380.2750  
 TELEPHONE 610.429.4533 FACSIMILE 610.429.0293  
 Members of the American Society of Landscape Architects